

Household Oxygen Concentrator

Model:ZY-1F/ZY-2F

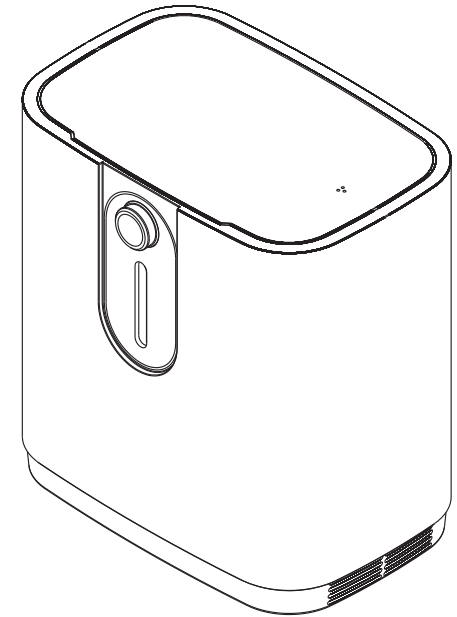

- Thank you for purchasing and using our oxygen generator
- Please carefully read this manual before use, in order to correctly operate
 - Please properly keep this manual so that you can check it at any time
 - Please use this oxygen generator under the guidance of medical staff
 - The pictures are for reference only.Please refer to the real object



PREFACE

Product intended use



noted

The nasal oxygen cannula is provided by the customers themselves. Please use the nasal oxygen cannula product with the medical device registration.

The warnings and cautions shown here are used for the correct and safe use of the product, in order to prevent harm or damage to the users or others.

Warnings and notes are as follows:

Legends	Contents
Warning	It is possible to cause casualties if the wrong use
Note	It is possible to cause personnel injury or product damage when it is used incorrectly
ⓘ	Signs indicate mandatory (things that must be observed). The specific mandatory content is represented by text or pattern, and the left figure shows "general mandatory".
⊘	Signs indicate forbidden (things that must not do). The specific forbidden content is represented by text or pattern, and the left figure shows general forbidden.

Dangerous

Smoking is prohibited during the using of this product. Please do not place the fire source in the room of the oxygen generator.

Warning

Please do not use this product without reading the instructions, you can contact the manufacturer or technical personnel.

Accessories warn

Please do not use another Accessories,only can use our factory products. Other factory's products may cause our products damage,do not use.

Noted

Please do arrange another machine to ready ,if this machine stop or break.you can ask your doctors or hospital.

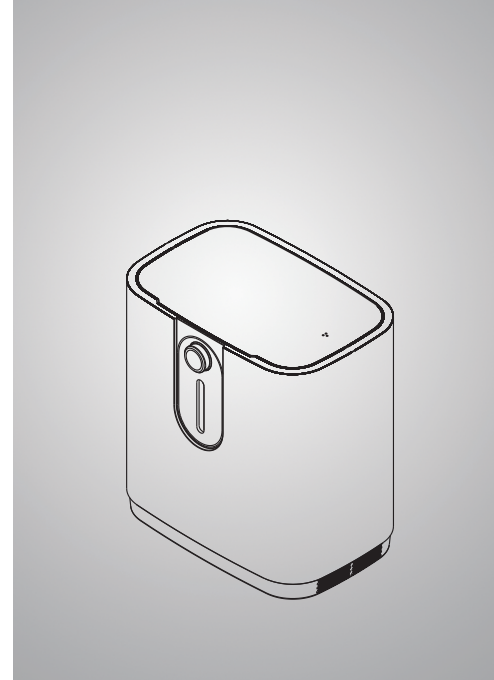

CONTENTS

security profile	01
Product features	02
Product Structure	04
Maintenance	08
Trouble Shooting	10
Matters needing attention	11

1 Security profile

Danger be careful of electric shock, do not disassemble the machine privately.

warn

Smoking is prohibited during using this product.

Please do not place the fire source in the room of the oxygen generator.

Please do not use this product without reading the instructions, you can contact the manufacturer or technical personnel.

Noted: please do arrange another machine to ready if this machine stop or break .

Do not move the machine by pulling the power cord.

Do not drop and plug foreign objects to the exit.

When adding humidifier, add proper water, do not add too much water to avoid overflow.

Oxygen generator should be placed in the indoor ventilation area to avoid direct sunlight.

Recommended use of standard nasal tube

When you do not use the machine, please unplug the power supply.

Before use :

Attention for opening the carton:keep the carton,if you do not use the machine right now.

Transportation and storage conditions

Ambient temperature range: -20 °C ~ +55 °C.

Relative humidity range: ≤93 %, with no condensation.

Atmospheric pressure range: 500 h Pa - 1060 h Pa.

Note: The oxygen generator should be stored in a room with no strong sunlight, no corrosive gas and good ventilation. Avoid severe vibration and inverted lying in transportation.

Symbols and meanings related to safety in this machine

Symbols	Implication	Symbols	Implication
~	Alternating current	⚠	Caution!
□	Devices of class	🧑	Type B application section
○	Disconnection (general supply)		Connection (general supply)
○	Disconnection (part of the device)	⦿	Connection (part of the device)
🚫	No smoking	↑↑	This side up
📦	Stacking limit by number	☔	Non-rainproof
🍷	Fragile		

2 Product features

Overview¹

Oxygen absorption function: By oxygen absorption, it can effectively improve the body's hypoxia condition and achieve the purpose of oxygen supplement health care. It is suitable for the elderly, women and the infirm, and students with different degrees of hypoxia. It can also be used to eliminate fatigue and quickly restore body function after physical or mental strenuous exercise.

This product is a high quality molecular sieve that absorbs oxygen (PSA extracts oxygen directly from the air). The oxygen machine is small in size, light in weight, low in power, low in noise, and simple in operation.

Scope of application²

For families and individuals to make oxygen.

Caution, contraindication: unfit for surgery, first aid and critically ill

Product technical indicators

3

- 1.ZY-1F and high-profile version, ZY-2F and high-profile version. Flow rate is divided into 7 levels. Press the flow button on the screen to adjust the required flow.
 - 2.ZY-1F and high matching version models,the oxygen purity is $\geq 90\%$.When the flow rate is 1L / min , ZY-2F and high matching version models,the oxygen purity is $\geq 90\%$.When the flow rate is 2L / min.
 - 3.Machine noise: <60dB(A)
 - 4.Power supply: AC220V/50Hz or AC110V/60Hz
 - 5.ZY-1F and high-profile version, input power is 120W, ZY-2F and high-profile version, input power is 170W.
 - 6.ZY-1F and high-profile version, the weight is 6kg , ZY-2F and high-profile version, the weight is 7kg.
 - 7.Dimensions: 284x187x302(mm)
 - 8.Altitude: The oxygen concentration does not reduce at 1828 meters above sea level, and the efficiency is less than 90 % from 1828 meters to 4000 meters.
 - 9.Security system:
 - Current overload or loose connection line, machine halt;
 - High temperature of compressor, machine halt;
 - 10.Minimum working time: no less than 30 minutes;
 - 11.Normal working environment:
 - Ambient temperature range: 10 °C - 40 °C;
 - Relative humidity $\leq 80\%$;
 - Atmospheric pressure range: 860 h Pa - 1060 h Pa;
- Note: The equipment should be placed in normal working environment for more than four hours before use when the storage temperature is lower than 5 °C.
- 12.Electrical classification: Class II equipment

Working principle

4

The air is compressed by an oil-free compressor,and the compressed air enters the inlet P of the electronic valve,which is controlled by a control plate. When the solenoid valve is powered on,the compressed air flows from P to a,then from the electronic valve a to molecular sieve(A bed),nitrogen in the air is absorbed by molecular sieve. Stabilize the pressure output,control the oxygen flow through the flow meter.The analytical pore enters the molecular sieve (B bed),flushes and desorbs the B bed ,and the desorbed gas is exhausted to the atmosphere through the exhaust muffler of the solenoid valve B port.

When the solenoid valve has no electricity,compressed air flows from P-B,then from the electronic valve a port to molecular sieve(B bed),nitrogen in the air is adsorbed by molecular sieve,Stable pressure output,another path of analytical hole into molecular sieve(A bed) After washing and desorbing the bed B,the desorbed gas is discharged into the atmosphere through the exhaust muffler of the solenoid valve B port.

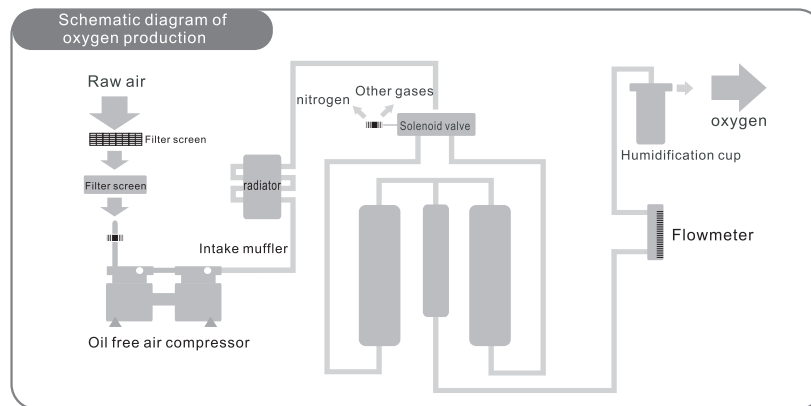

Fig.1

3 Product Structure

Fig. 2 Schematic diagram of display screen

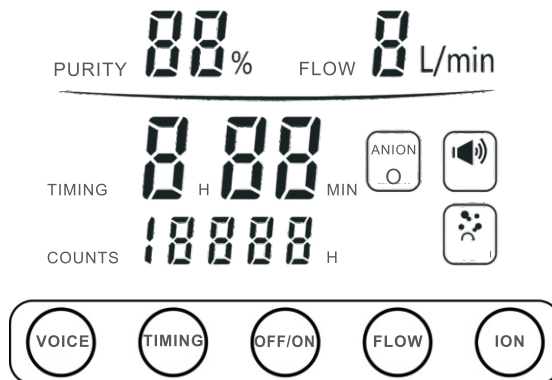

Fig.2

3 Product Structure

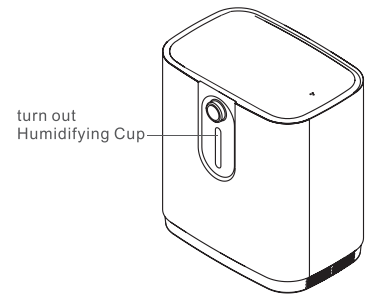

Fig.3

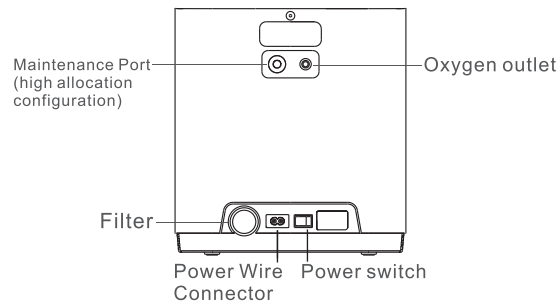

Fig.4

4 Installation & Operation

1 preparatory work

1. Take the machine out of the carton and eradicate the material of package.
2. The right hand holds down the oxygen generator, pulls out the wet cup in the direction of the icon, pulls out the top cap, adds cold water, and the water level can not exceed the highest indicator line (the wet cup does not add water, but also produces oxygen, adding water, humidifies the role of oxygen, No effect on oxygen production)
3. Tighten the wet bottle cap and reload it into the machine (wet bottle foot pointed at the machine shell hole).
4. Connect the power cord: Make sure the machine is closed, connect one end of the power cord to the oxygen generator and the other end to the socket, and do not use the power extension line.

4 Installation & Operation

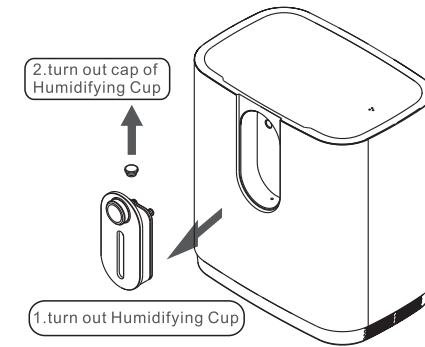

Fig.5

2 operation of oxygen

Put the switch "I" and turn on the switch when the label is bright on the screen, and the machine are working. After several seconds, the machine has the voice of gas. (it can be at good working condition 30 minutes after turn on) The oxygen flow is divided into 7 files. According to the flow buttons on the display screen, you can adjust the required flow rate.

ZY-1F and high-profile version, ZY-2F and high-profile version. Flow rate is divided into 7 levels. Press the flow button on the screen to adjust the required flow.

- * Connect one end of the oxygen suction tube to the oxygen outlet of the oxygen generator, and the other end is worn well with the oxygen absorber and you can begin to absorb oxygen.
- * Time and oxygen flow, adjusted by demand.
- * Oxygen end, close oxygen generator and remove oxygen terminal.

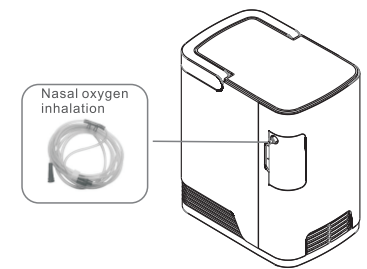

Fig.6

Timing Settings ³

Each press has 30 minutes incremental, timed up to 4 hours, more than 4 hours of automatic circulation, if timed at 0, the machine is continuous state.

Voice: ⁴

🔊 The machine has the voice function, it can be closed.

Turn off the machine ⁵

- * It can be turned off by switch of turn on/turn off.
- * remove the connecting pipe from the oxygen outlet when finish use the machine, then turn off the power, and pull out the plug.

Maintenance Port (For Maintenance Port) ⁶

It is used to remove water vapor from the high-pressure condensation frost of the oxygen generator and improve the service life of the oxygen generator. Under the condition of oxygen production, when the sealing cap is rotated, the water vapor will be removed and kept for about 10 seconds, it can be discharged. After that, please tighten the cap.

5 Maintenance

Clean the shell: Wash it at least once a month, first disconnect the power and then wipe it with a soft towel and ensure the liquid can't flow into the machine.

Clean or replace filter.

Cleaning and replacement of filter is important to protect compressors and molecular sieves, and can extend the life of the machine. Please replace or clean up in time.

- ⚠ **Caution:** when filter are wet or not installed, machine must not be used. Filter should be replaced after working for 100 hours.

1. Removal of filter and filter mat.

The filter and filter felt are pulled out from the back of the machine, and the air inlet filter cover is pulled out. The felt can be removed directly. felt should be cleaned according to the actual use. If there are obvious stains, wash or replace them immediately, regardless of their length.

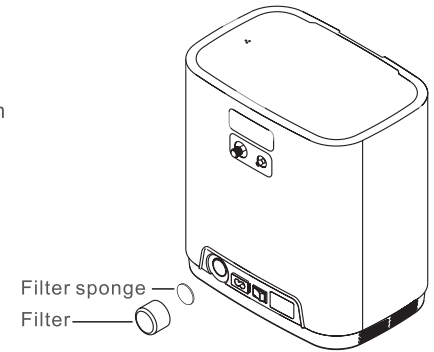

2. clean

First wash with detergent, then rinse with water, then dry, then install on machine.

3. Humidifying cup cleaning.

Weekly wash the humidified cup, wash it with detergent first, then wash it with water. If it smells bad, soak it in vinegar for half an hour, then clean it.

4. Nasal tube cleaning

Clean the test tube every 3 days. every time clean the nasal tube after using, when you smell bad. You can soak it in vinegar for half an hour or use medical alcohol. Advise that you should change the nasal tube every 2 months. (the inside of the nasal tube should keep dry after you clean the the nasal tube).

6 Trouble Shooting

Phenomenon of breakdown	Analyses of breakdown	Processing method
The oxygen generator does not work or the indicator light is off after turning on the power switch	1.The power plug is in bad contact with the power socket.	1.Plug the power cord firmly.
	2.The outlet has no power output.	2.Move to a socket with electricity.
	3.Main board damage	3.Replaced by professionals
After starting,the running sound of the machine is normal,the flow is adjusted normally,but there is little or no feeding.	1.Is there any defect in the oxygen inhaler	1.Replace of oxygen inhaler
	2.There is a gap between the humidifying cup and the humidifying cup cap, which is not sealed.	2.Retighten the lid of the humidifier or replace the humidifying bottle.
	3.The humidifying cup and the machine are not installed in place.	3.Reinstall humidifier bottles,humidifier bottles and machines should be operated horizontally.
	4.The humidifying cup inlet seal ring is damaged or missing.	4.Replace or reinstall intake seal ring
Turn on for a while.Machine temperature is very high or directly shut down.	1.Obstruction of intake or exhaust	1.The oxygen generator should be placed in the ventilation area,and distance to the concrete walls and furniture should be at least 10cm.
	2.Inlet filter cotton dirty	2.Check whether the air inlet sponge behind the machine is blocked or dirty and clean up in time.
	3.Machine temperature is too high.	3.When the machine leaves the factory, there is a high temperature protection device.If the machine stops because of high temperature, turn off the switch and check whether the filter sponge is dirty in the inlet and outlet,or whether the air inlet or outlet is blocked. Wait until the machine temperature drops,then restart.
Regular or slight popping exhaust sound.	Normal	It is a normal phenomenon that the machine extracts oxygen and excludes other gas ,and make noise.

7 Matters needing attention

- Please read the instructions carefully before use
- Oxygen is a combustion-supporting gas. Please do not smoke and avoid open flames.
- Do not start frequently to prevent the oxygen generator from starting with pressure, resulting in breakdown and affecting service life.
- Do not use if the power cord is damaged or the plug may cause unsafe conditions.
- Ensure that the air inlet and exhaust ports of the oxygen generator are unobstructed, and the distance between the exhaust port and the obstacle is not less than 15cm.
- Please replace the water stored in the humidifier before daily oxygen inhalation. If it is not used for a long time, the water in the humidifier should be poured out.
- The oxygen generator should be exclusively for personal use and ensured its hygienic use.
- Waste and residue should be disposed in accordance with relevant national regulations.

Product recovery:

If the products and instructions are lost, it will cause pollution. This logo can recycle products.



Packing list

Thank you for your purchase of our oxygen generator. Unpack the box according to the following packing list. If there are any defective parts, please submit them to the salesperson in time and exchange them.

Serial number	Name	Number	Unit
1	Oxygen generator	1	set
2	Power cables	1	line
3	Nasal oxygen tube (test machine gift)	1	pair
4	Filter	1	pcs
5	Filter felt	1	pcs
6	Certificate of conformity	1	pcs
7	Instruction manual	1	book
8	Remote control (Optional)	1	pcs

Changes in circuit and appearance due to machine improvements are not notified